

Product and Company Identification

Product Name: **HD Series**
 Manufacturer's Name: **Prospec Specialties Inc.**
 Suite 400, 3601, Highway 7,
 Markham ON, L3R 0M3, Canada
 Emergency #: (888) 749-8456
 Date Prepared: June, 2013

Table 1: System Details

Application	Code	JO	SH	SW	± Movement (%)			Load (Ton)
		Millimeter			Horizontal	Vertical	Shear	
Straight (S)	HDS 01	25	4	60	50	25	Excellent	1.5
	HDS 02	51	4	85	50	25	Excellent	1.5
	HDS 03	76	4	123	50	25	Excellent	1.5
	HDS 04	102	4	152	50	25	Excellent	1.5
	HDS 06	152	4	203	50	25	Excellent	1.5
Corner (C)	HDC 01	25	4	50	50	25	Excellent	1.5
	HDC 02	51	4	83	50	25	Excellent	1.5
	HDC 03	76	4	120	50	25	Excellent	1.5
	HDC 04	102	4	150	50	25	Excellent	1.5
	HDC 06	152	4	200	50	25	Excellent	1.5

JO = Joint Opening **SH** = System Height **SW** = Sight Width

Key to System Features (Straight Application)

1. Continuous Aluminum frame, grade 6063-T6, anodized finish
2. Stainless Steel spring clips, (7 nos. per length)

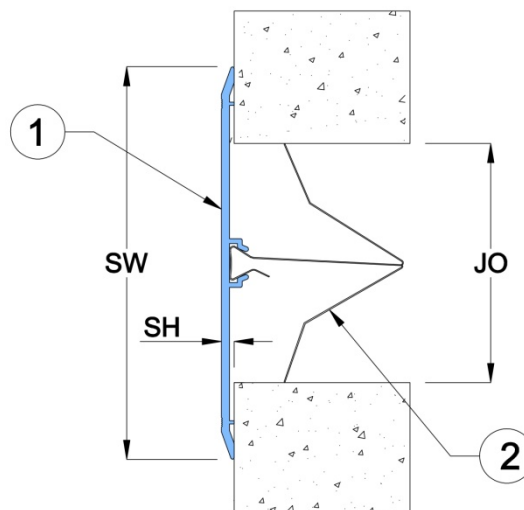

Key to System Features (Corner Application)

1. Continuous Aluminum corner frame, grade 6063-T6, anodized finish
2. Stainless Steel spring clips, (7 nos. per length)

